

Horten Headquarters

Copenhagen, Denmark





Project Description

The 'Domicil Horten' is the new headquarter of the danish law company 'Horten'. Lindner was responsible for the complete interior fit-out of the office building. The building was designed nearly without rectangular corners and as consequence, the interior fit-out was carried out with a multitude of curved elements.

Partition Systems Glass
Wall and ceiling panels

- Carpentry
Plasterboard ceiling systems
Plasterboard partition systems
Floor covering works
Natural and artificial stone works
Furniture

General

Building Type	Office buildings
Company Division	Lindner SE I International Projects Contracting
Completion	2008 - 2010
Architect	3XN A/S
Client	Carlsberg A/S Ejendomme

Completed Works

- Ceilings
Post Cap Ceilings
Hook-On Ceilings
- Floors
Calcium sulphate panels
FLOOR and more®
FLOOR and more® comfort
- Partitions

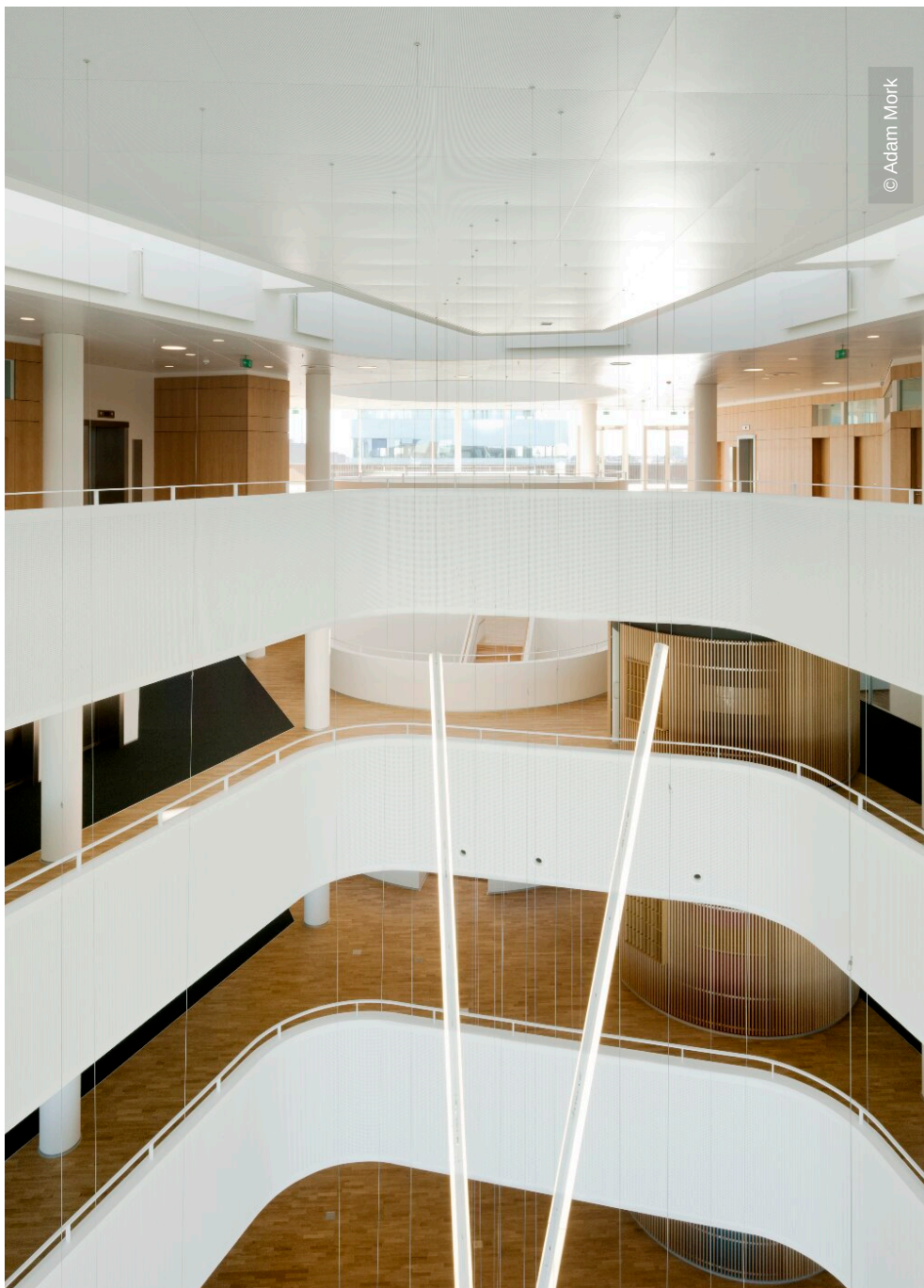

© Adam Mørk

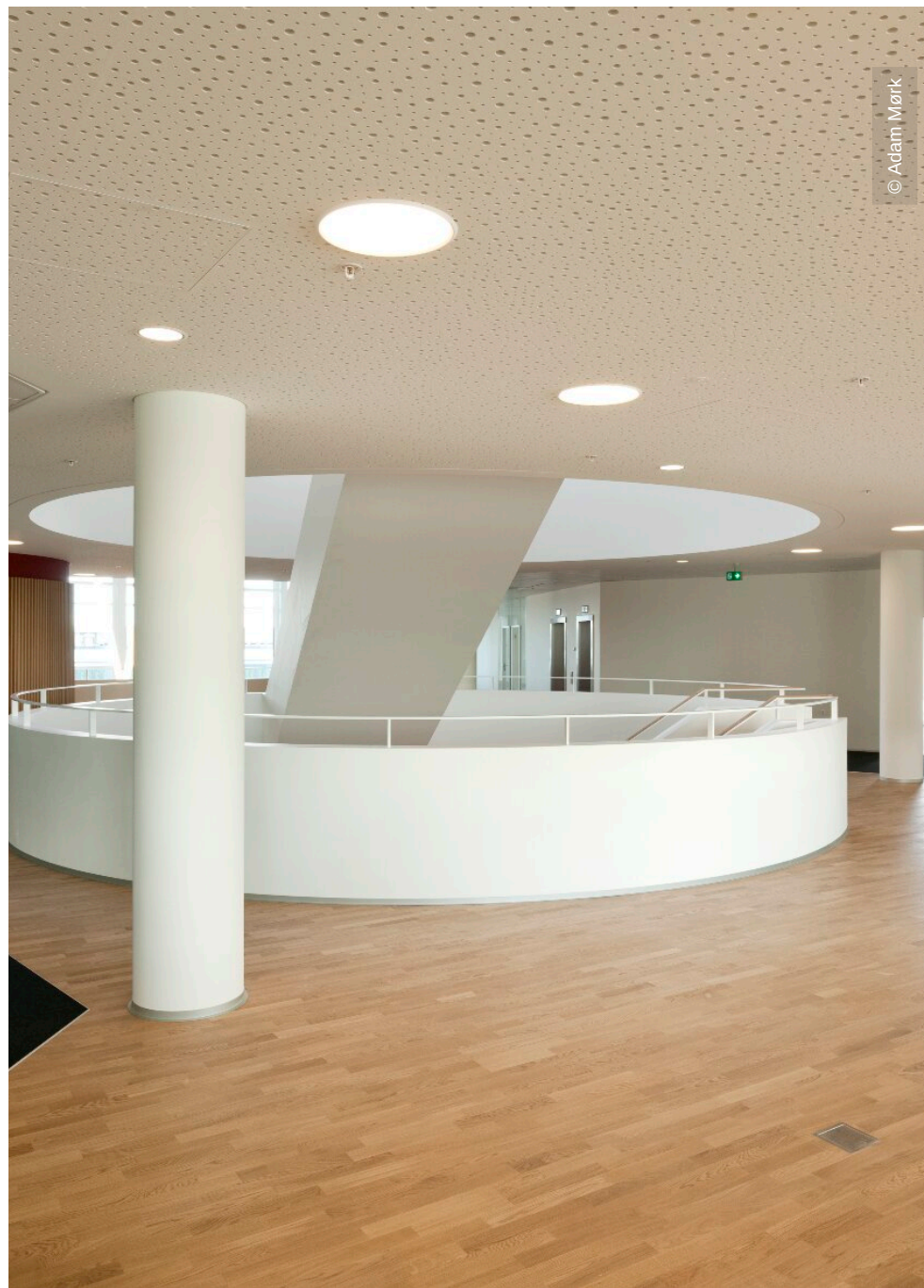

© Adam Mørk

