



Surface-mounted LED ceiling light for junction from ceiling to wall.

The lights may be mounted in a row adjacent to each other. Suitable pieces are available for corners.

Thanks to its design, the light fits seamlessly in the junction between wall and ceiling.

Very efficient and long-life LED modules are used.

Cover contained in frame.  
Attached using knob fastener.

Type	Lighting system	Approx. size W x L x H
DL LED 650 2.0 bAG	LED 840, 2350 Lm, ca. 21Watt	140 x 650 x 140 mm
DL LED 900 3.5 bAG	LED 840, 3530 Lm, ca. 31Watt	140 x 900 x 140 mm
DL LED 1200 4.5 bAG	LED 840, 4700 Lm, ca. 41Watt	140 x 1200 x 140 mm
DL LED 1500 6.0 bAG	LED 840, 6080 Lm, ca. 54Watt	140 x 1500 x 140 mm

## Technical Data:

**Voltage:** 220-240 V / 50-60 Hz  
**Protection class:** 1  
**Protection rating:** IP65 IP 20 on back side, optional IP54 on back side  
**Control unit:** switchable, optional DALI dimmer  
**Elec. connection:** internal 3-pin plug (DALI 5-pin) with straight wiring option  
**Colour:** RAL 9016 / customer choice  
**Glass:** toughened safety glass

## Scale diagram:

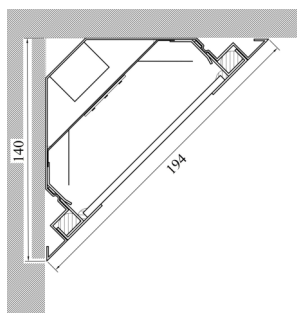

## Light distribution curve:

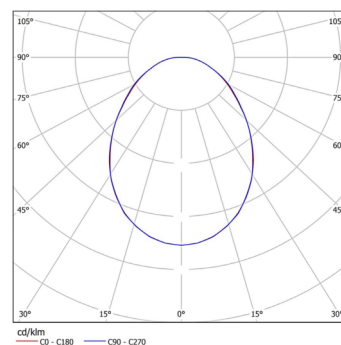

## Options:

- emergency light
- elec. connection according to customer requirement