

BASF Business Center D105

Ludwigshafen, Germany





Project Description

The newly constructed Business Center D105 extended the capacities of BASF at their headquarters in Ludwigshafen am Rhein. The building offers a net floor area of 38,000 sqm on seven floors. When the concept for this development was established, one of the main endeavours was to create an environment for a staff of up to 1,300 that offers both functionality and sustainability. A certification according to DGNB Platin is sought for this building. In regard of its use, the building presents itself as a multi-functional and high-quality office building with substantial conference facilities. Lindner participated in this development as a general contractor. The commission included the fitting of Plafotherm® Plasterboard heated and chilled ceilings in the prestigious entrance hall, which also saw the execution of other dry construction and plastering works, similar to other parts of the building. The office areas have been fitted extensively with Lindner Metal Ceilings, partly executed with integrated heating and cooling technology. In order to create spatial separation in these areas, Lindner Partitions with integrated doors have been installed. Further doors made from wood and stainless steel were also part of the performances executed. A visual break from other facilities is found in the conference area and the canteen, where in both cases perforated baffle ceilings with partially integrated heating and cooling technology have been installed. The staff canteen stands out particularly with its undulating LMD-L LAOLA and integrated LED luminaires. The performance spectrum of Lindner Group is rounded up with several fixed furnishings and the stage of the conference area as a custom construction.

General

Building Type	Office buildings
Company Division	Lindner SE Fit-Out Central.East Germany, Lindner SE Heated and Chilled Ceilings
Completion	2014 - 2016

Client	BASF SE
Architect	HPP Hentrich-Petschnigg & Partner GmbH & Co. KG

Completed Works

- **General contractor**
 - Wooden doors
 - Plastering works
- **Dry lining**
 - Plasterboard partition systems
 - Plasterboard ceiling systems
- **Ceilings**
 - Fire Rated Metal Ceilings - DIN 4102-2
F30 Swing-Down-Slide
 - Metal Ceilings
 - Heated and Chilled Post Cap Ceilings
 - Heated and Chilled Hook-On Ceilings
 - Heated and Chilled Baffle Ceilings
 - Heated and Chilled Plasterboard Ceilings
- **Partitions**
 - Partition Systems Glass
 - Doors for Partition Systems

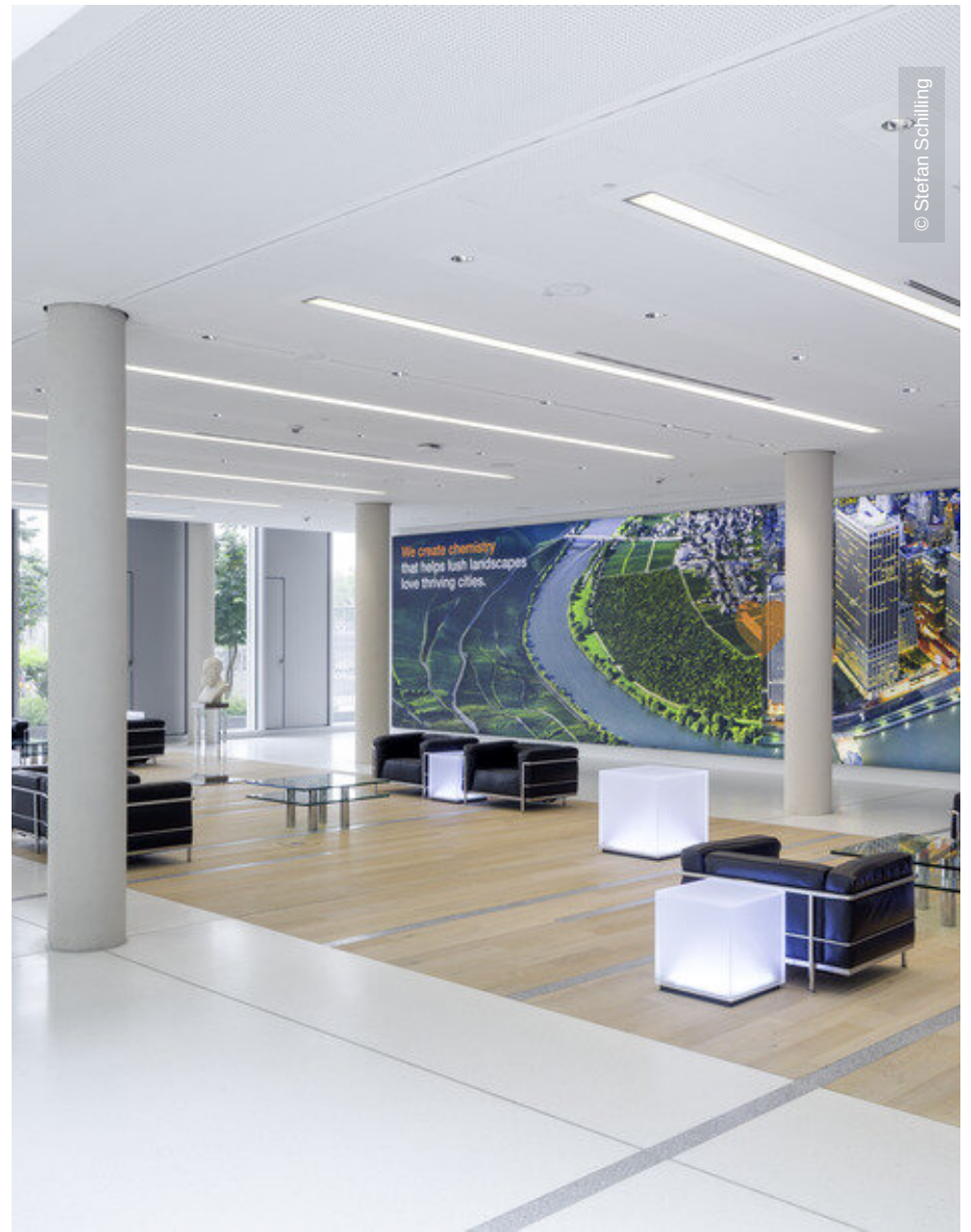



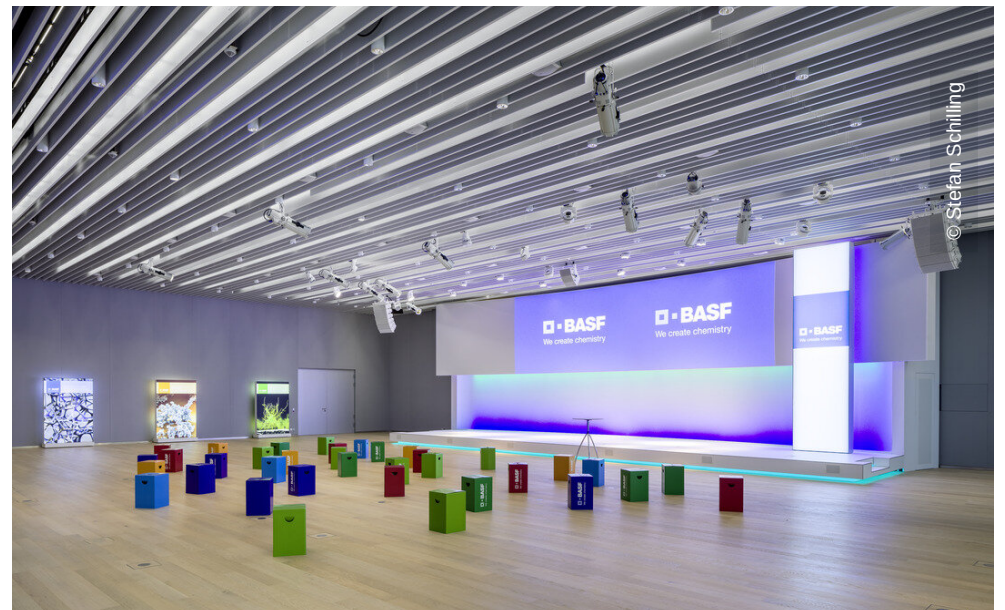
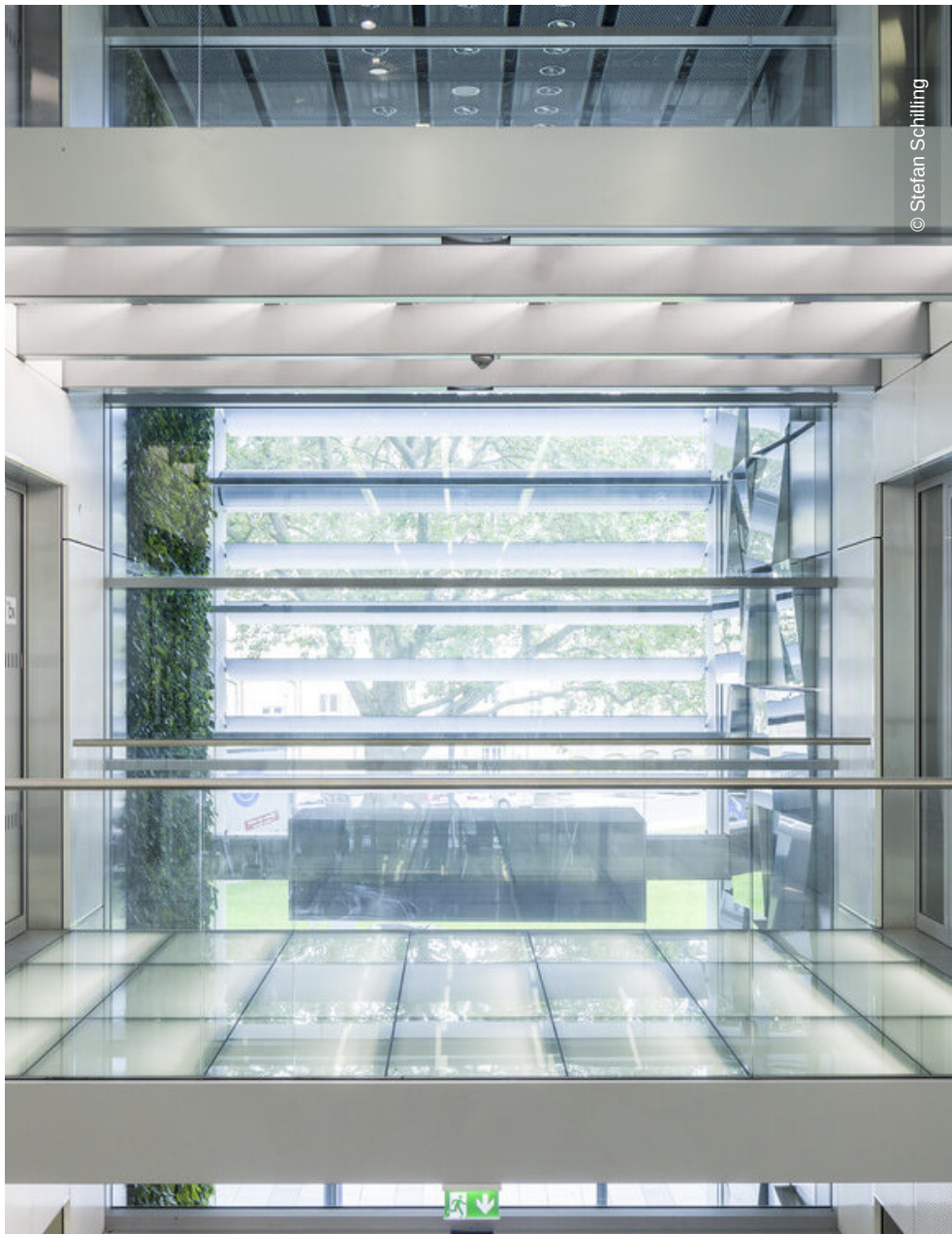



© Stefan Schilling

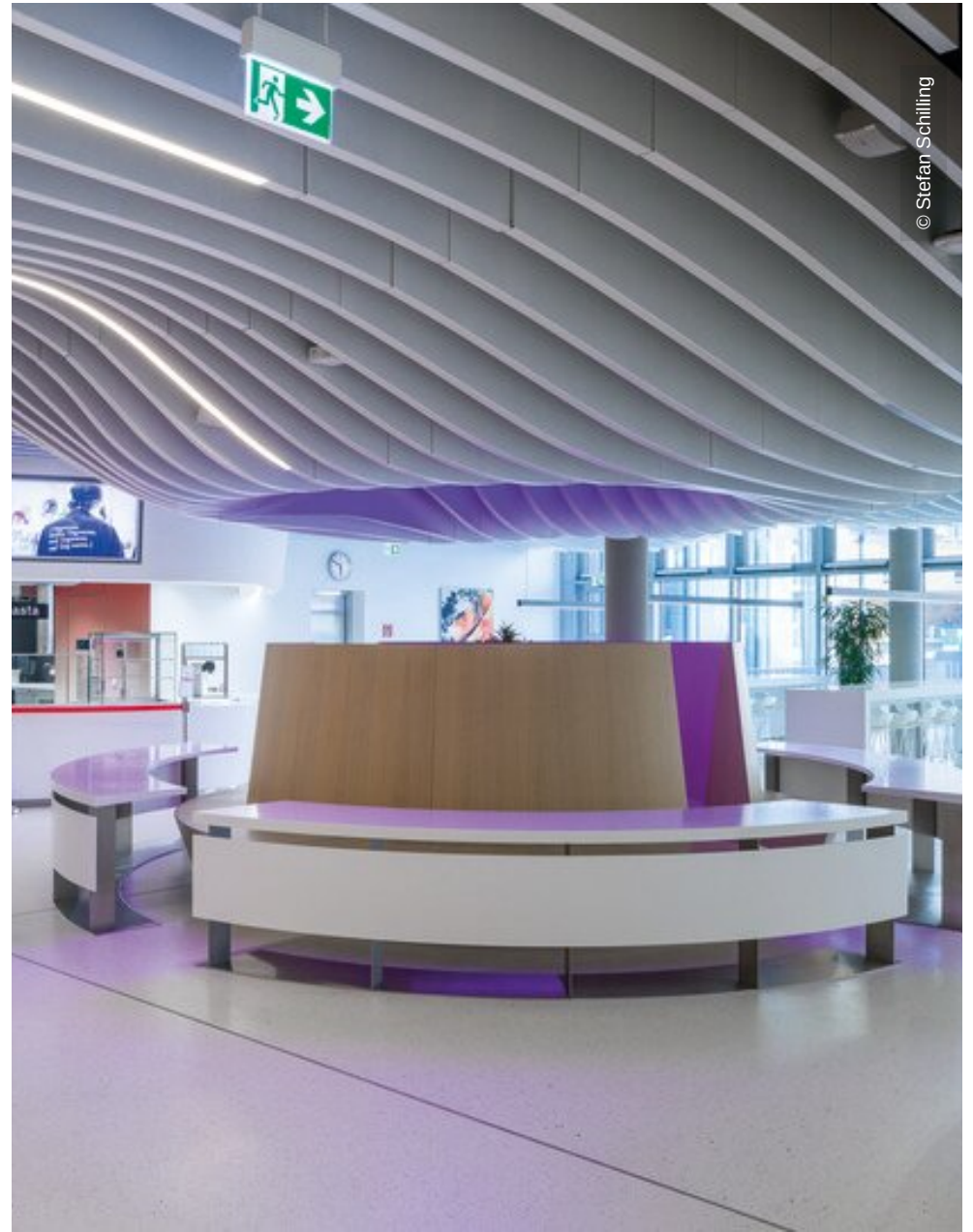

© Stefan Schilling

