

Neue Schule Wolfsburg, Extension SEKI

Wolfsburg, Germany

 **Lindner**



© www.Lindner-Group.com

Project Description

Established in 2008, the "New School of Wolfsburg" is a showcase project for a new education concept with intertwined primary and secondary school that supports individual talents of children and adolescents, which also sees the integration of external experts and places of learning.

The new construction of the secondary school's level 1 houses class rooms for several subject areas as well as the school administration and a central event area called the "common centre". When the building's concept was drafted, great emphasis had been laid on creating a friendly, motivating and open learning environment. This endeavour can be found both in the open and transparent design of the construction as well as in the modern class rooms with professional equipment.

The interior design was reduced to calm and harmonious materials, including glass, concrete and wood. Class rooms become transparent through the integration of room-high Lindner Life Stereo 125 Glass Partitions with triple glazing, fitted in a black circumferential aluminum frame, setting colourful accents in an otherwise mostly clear wall design. These systems are combined with massive wooden doors and frames as well as glazed doors with aluminum frames.

As demanded by school construction regulations, the doors and partitions are in accordance with sophisticated fire, smoke and noise protection standards. The same applies to spandrel glazings and windows that have been integrated in walls with connection to the central atrium and between classrooms and hallways.

General

Building Type	Schools
Company Division	Lindner SE Interior, Lindner SE Partitions
Completion	2016
Client	City of Wolfsburg
Architect	Work Phases 1 - 4: Kirstin Bartels ARCH

Completed Works

- **Partitions**
Partition Systems Glass
- **Doors**
Wooden doors
Aluminium Tubular Frame Doors



© www.Lindner-Group.com

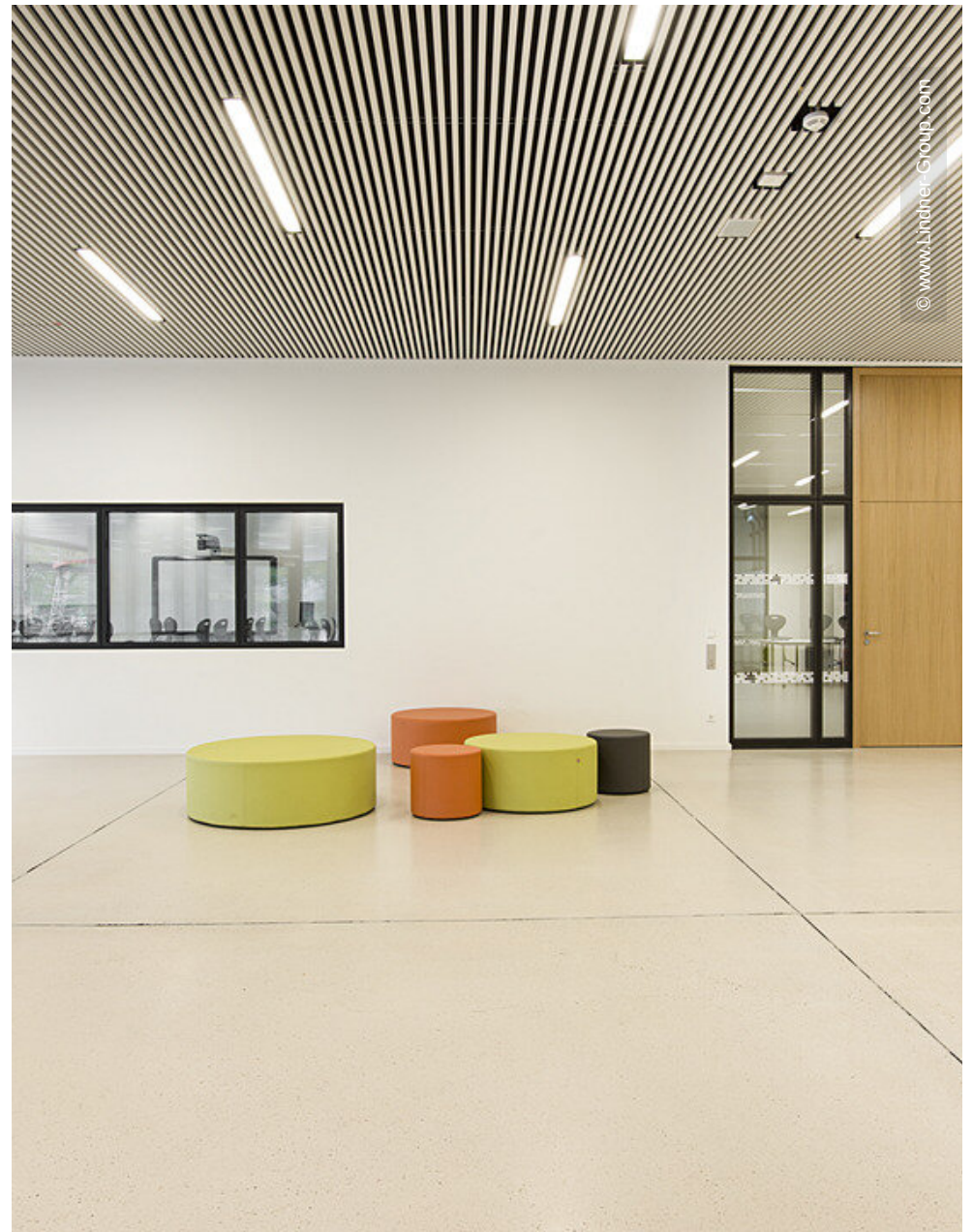

© www.Lindner-Group.com



