

Hessenwald School

Weiterstadt, Germany





© Brígida González

Project Description

A three-part building ensemble was built in a forest clearing near the South Hessian town Weiterstadt for the education of about 700 students. The ambition to become a culturally leading school in Hessen is pursued with a unique concept that also affects the architecture. The heart of this general school is a spacious, multi-functional atrium with its extensive galleries and staircases. This large-scale centre not only acts as a place of congregation during breaks, but also as an event venue for concerts, presentations and readings.

Being a specialist for interior fit-out and furnishings, Lindner was awarded the contract for the production and installation of real wood-veneered claddings for stairs and walls of the atrium as well as the wooden fire and smoke protection doors that were integrated into the escape routes. Furthermore, Lindner produced various furnishings such as built-in cabinets, kitchenettes, bars, display cases as well as the central stage in the atrium and mobile partitions.

- **Doors**
Wooden doors

General

Building Type	Schools
Company Division	Lindner SE Interior
Completion	2015 - 2016
Client	Da-Di-Werk Service for Facility and Environmental Management
Architect	wulf architekten GmbH

Completed Works

- **Partitions**



© Brígida González

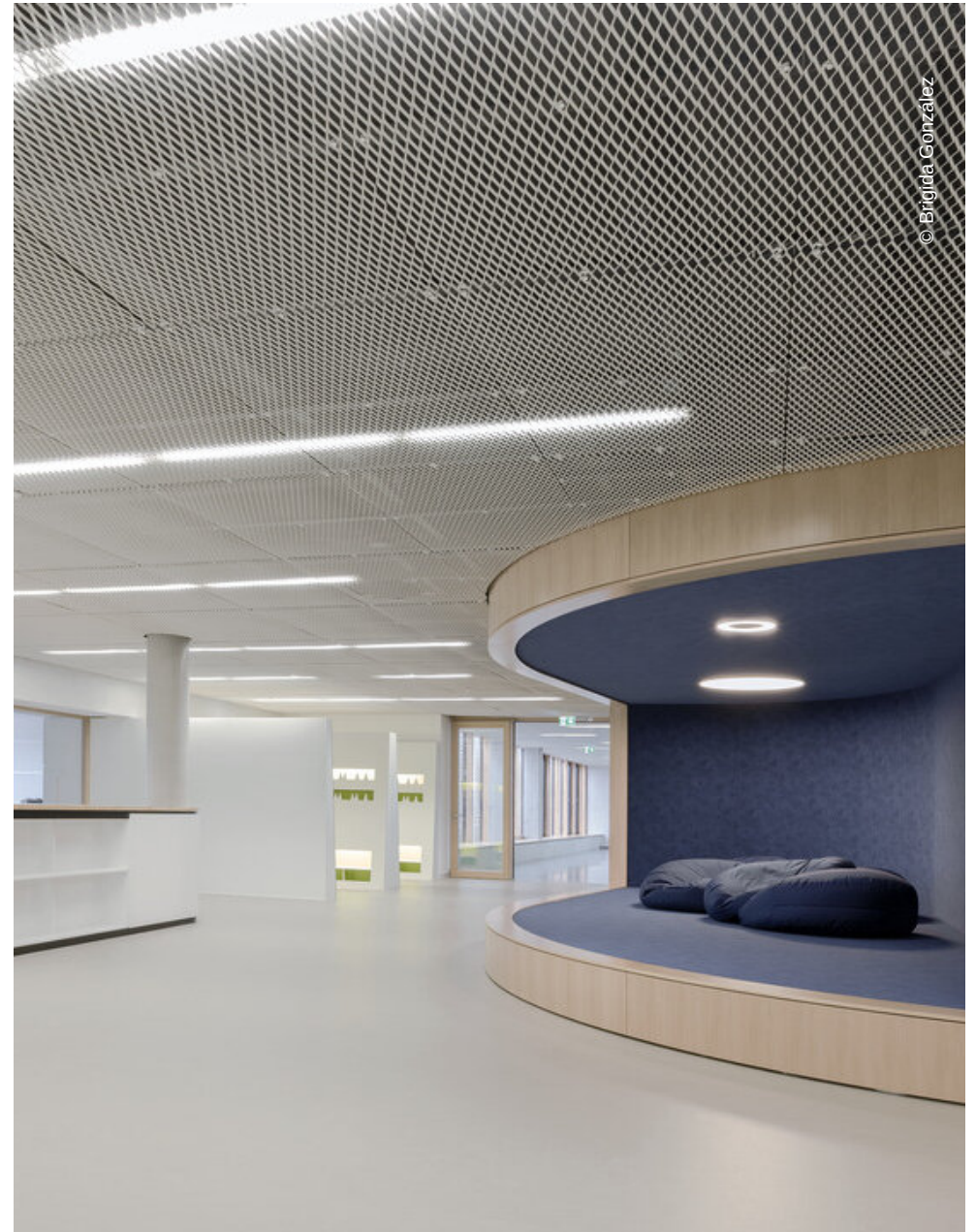

© Brígida González