

# Tower Riem - Brainlab Headquarters

Munich, Germany





© www.Lindner-Group.com

# Project Description

Brainlab AG of Munich-Riem not only treads new paths in software-based medical technology. The company has also implemented innovative working environments in a creative way. A distinctive part of the headquarters is the listed ten-storey tower of the former airport, which is connected via four bridges to the new office building. Lindner AG contributed large packages to the interior fit-out of the tower and the new building with its divisions Fit-out and Clean Room Technology (Reinraumtechnik). The challenge was to put an individual and themed design combined with several technical peculiarities into practice while meeting the requirements on hygiene. The close cooperation with the customer and their wishes led to the development of new custom solutions through Lindner Reinraumtechnik, such as an individualised door control system with touchless sensor operations. These solutions were combined with system products for ceilings, floors and partitions. Ceramic print on white glass, printed-on stainless steel and HPL panels, LED-backlit glass walls with individually adjustable RGB colours are only a few design elements that characterize the mock-up operation theatres that have been fitted out by Reinraumtechnik. A wavy mirror ceiling of type TOUCHdesign Lunar in the conference room of the tower as well as parallel baffle ceilings in bronze or black design in the museum and showroom area are part of the design concept that was stipulated by the customer and put into practice by Lindner. The central atrium and the office areas have been fitted with the hollow floors CAVOPEX and FLOOR and more®, which were finished with large-scale tiles, textile coating or parquet, respectively. Glass partitions of type Lindner Life Pure 620 with high-quality doors create spatial separation.

## General

<b>Building Type</b>	Office Buildings, Clinics and Hospitals, Multipurpose Buildings, Industrial and commercial construction, Public and institutional buildings, Others
<b>Company Division</b>	Lindner SE   Ceilings, Lindner SE   Floors, Lindner SE   Interior, Lindner SE   Partitions, Lindner SE   Clean Rooms, Lindner SE   Fit-Out South.Southwest Germany
<b>Completion</b>	2017
<b>Architect</b>	pmp Architekten

## Completed Works

- **Partitions**

Partition Systems Glass Lindner Life Pure 620	3000 sqm
--	----------

- **Ceilings**

Baffle Ceilings Design Surfaces TOUCHdesign Lunar	3000 sqm
---	----------

- **Floors**

Calcium Sulphate Panels FLOOR and more® NORTEC	1000 sqm 150 sqm
Nasshohlboden CAVOPEX	15100 sqm

- **Clean Room**

Clip-in cassette systems Clip K3	300 sqm
Partition systems OT Multiclean COP	1000 sqm
Integrated lights	30 Pcs.
Hinged doors	8 Pcs.

Sliding doors

7 Pcs.

- **General Contracting**

Painting works

55000 sqm

Plastering works

23300 sqm

Screed works

7500 sqm

Floor coating works

15000 sqm

Floor covering works

14000 sqm

Plasterboard ceiling systems

4600 sqm

Plasterboard partition systems

10300 sqm

Tiling works

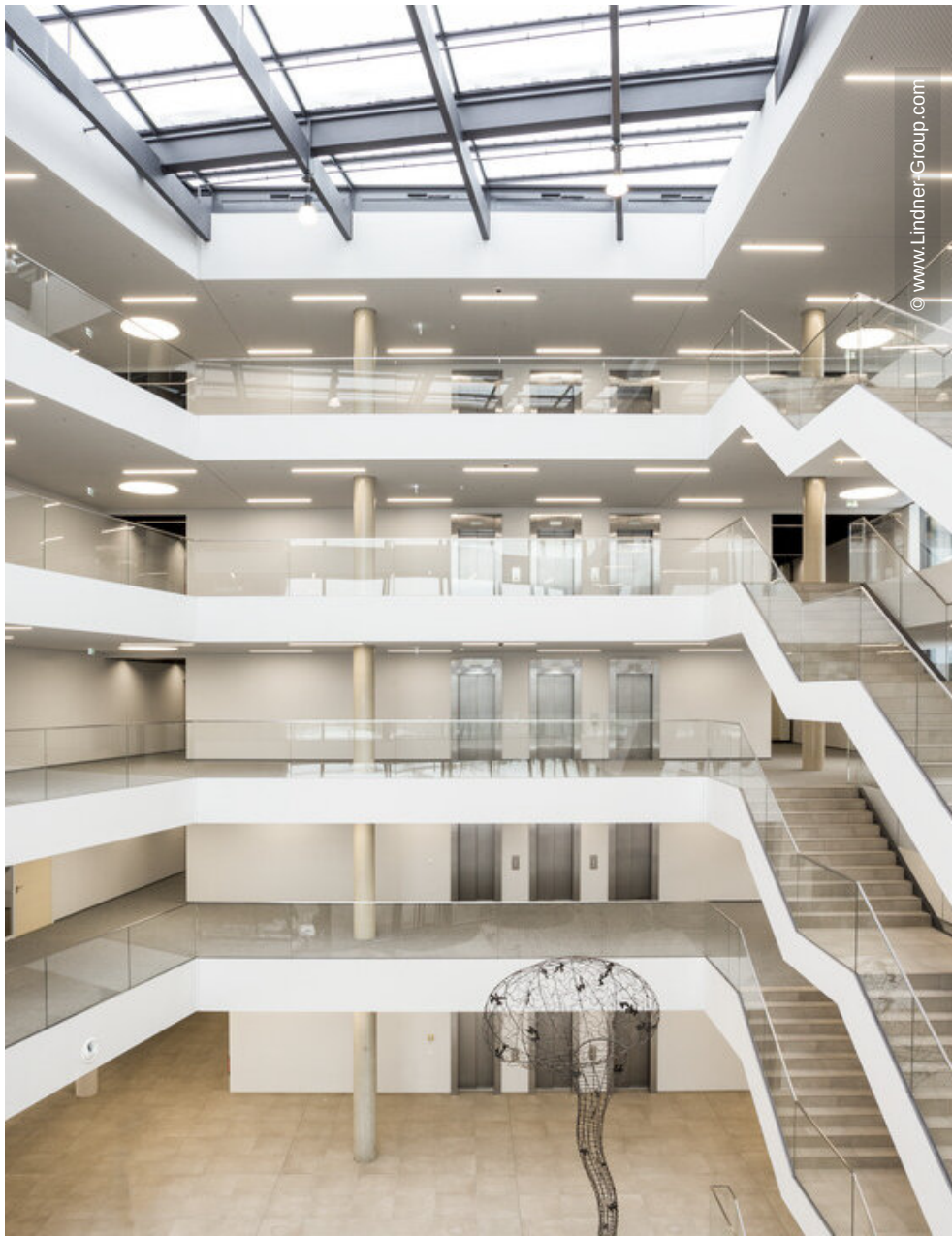

© www.Lindner-Group.com

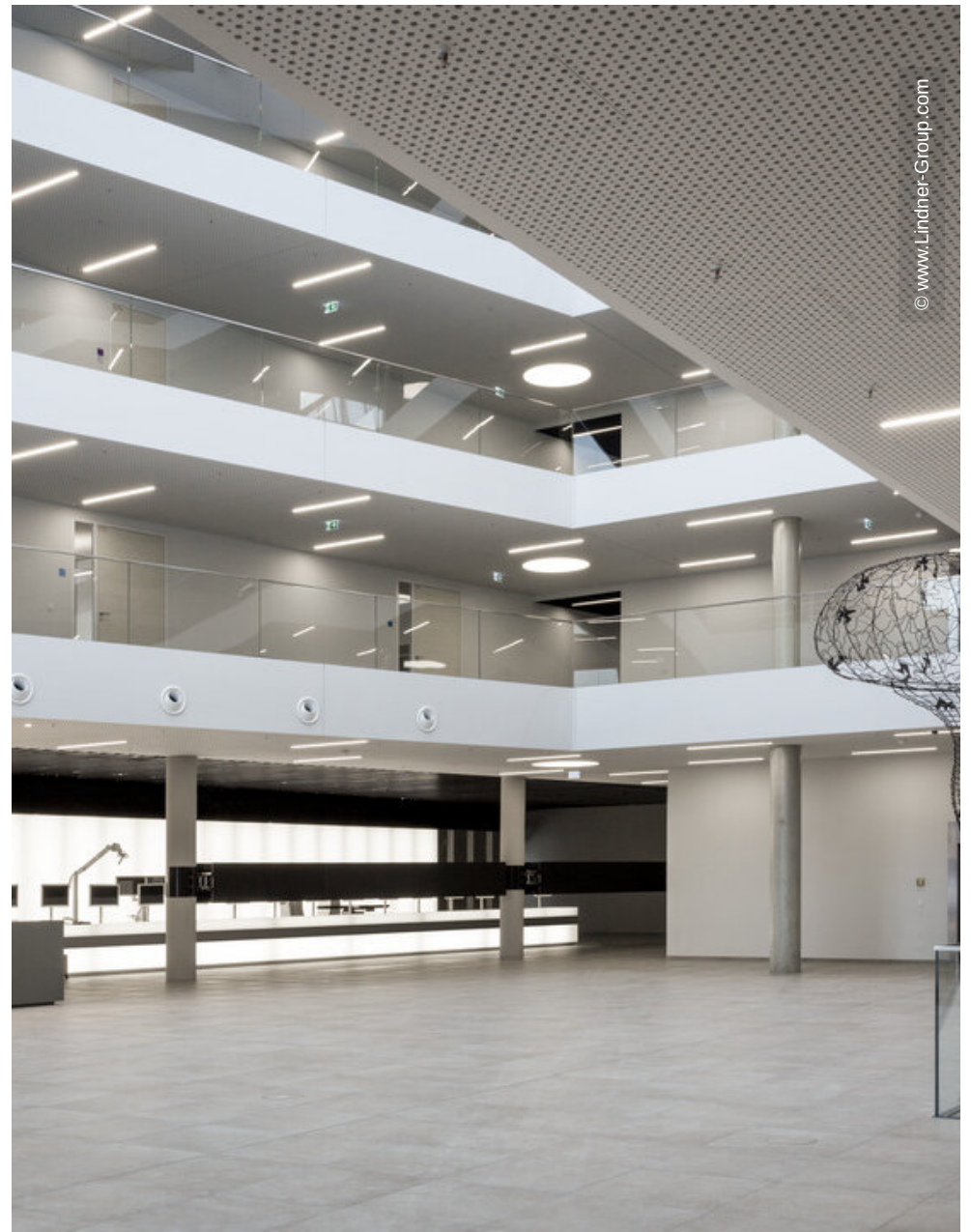

© www.Lindner-Group.com



© www.Lindner-Group.com



© www.Lindner-Group.com



© www.Lindner-Group.com



© www.Lindner-Group.com







© www.Lindner-Group.com



© www.Lindner-Group.com



© www.Lindner-Group.com

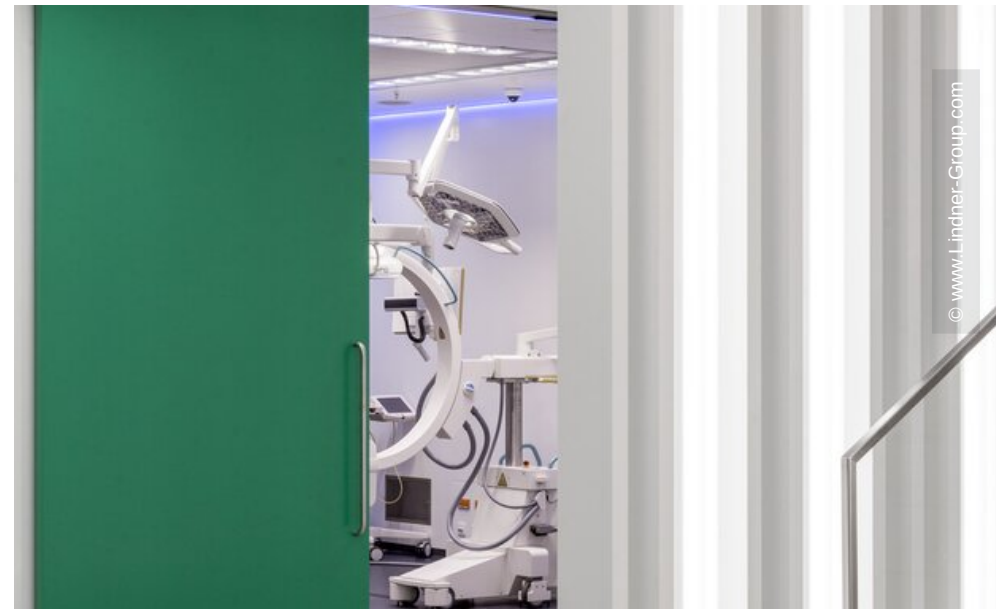

© www.Lindner-Group.com