

# **AFI Karlin Butterfly**

Prague, Czechia

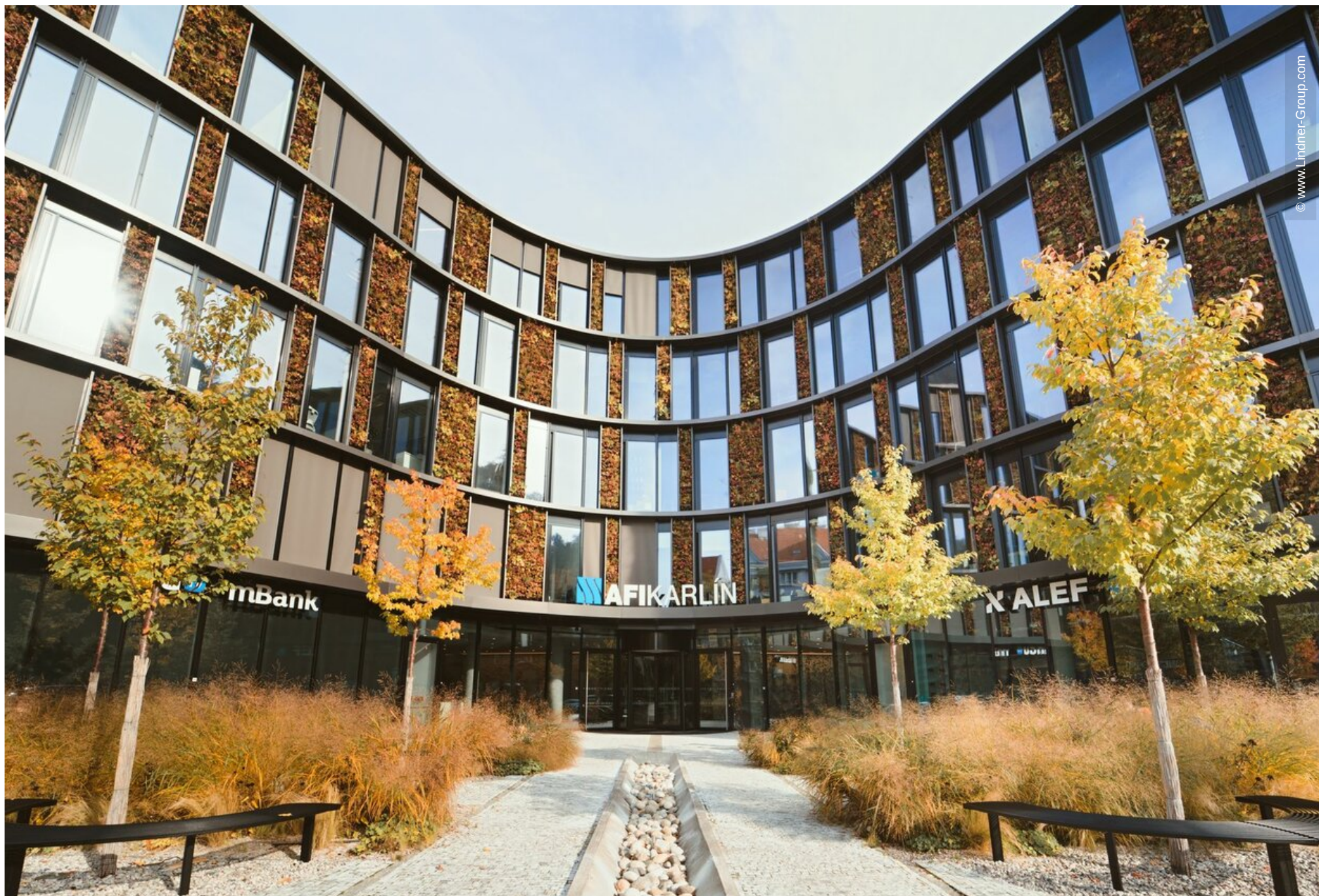







## Project Description

The conception and synthesis of CMC was inspired by the composition of the inverse shape - an elliptical, two-winged object - which on the one hand speaks to the industrial history of Karlin and at the same time adapts to the natural character of Vitkov. It was intended as a conceptual marriage of two opposing phenomena. AFI Karlin Butterfly was intended as a "living workplace" with a human scale and an emphasis on the quality of the environment.

The facades of AFI Karlin Butterfly are dynamic - they give the object the face of a living organism with 40,000 plants that grow, change and move over time. The atrium was designed as a place through which the building "breaths", where people walk outside and can still be inside.

From a functional point of view, AFI Karlin Butterfly contains rental business units, showrooms, cafes and restaurants on the ground floors. Above the ground are four "open space" office floors. Two underground floors are reserved for parking.

## Completed Works

- **Floors**

Chipboard Panels

LIGNA

Calcium Sulphate Panels

FLOOR and more®

## General

<b>Building Type</b>	Office Buildings, Hotels and Resorts, Restaurants and Catering Facilities, Multipurpose Buildings, Industrial and commercial construction, Sports and recreational facilities, Others
<b>Company Division</b>	Lindner SE I Interior Product Supply
<b>Completion</b>	2016 - 2018
<b>Client</b>	AFI Karlin s.r.o. (AFI Europe)
<b>Architect</b>	CMC architects

