

# Covestro

Leverkusen, Germany

 **Lindner**



# Project Description

Covestro AG moved into its new headquarters in the "chemical capital" of Leverkusen at the end of 2020 (with a reduced team due to the pandemic situation). The new administration building of the world's leading supplier of polymer materials, with six floors and modern office space, offers a lot of space and optimal working opportunities for up to 750 employees.

As the general contractor for the interior work, Lindner SE handled various trades from drywall construction to subcontractor services. The system walls, built-in furniture as well as counters, doors, ceiling and floor systems were produced in-house. In addition, Lindner Leuchtenfabrik (on behalf of the companies Kinzo and Signify) supplied design luminaires for work islands. Room-high, frameless full-glass walls allow natural light from the atrium into the inner areas. Lindner Life Freeze 137 glass partition wall systems create meeting rooms or "meeting boxes" as places of retreat in the otherwise open campus. Partly designed as curved glass wall elements, they underline the individual design claim and still meet the high static requirements.

On an area of more than 12,000 m<sup>2</sup>, you will find above all the Lindner raised access floor NORTEC with sufficient installation space in the floor structure, a high level of walking comfort and for acoustic regulation. For heavy-duty areas, the FLOOR and more<sup>®</sup> power access floor was chosen, mostly covered with textile flooring.

Among other things, 5,400 m<sup>2</sup> of the Plafotherm<sup>®</sup> GK HEKDA<sup>®</sup> heating/cooling ceiling system ensure optimised acoustics and a good indoor climate in the open spaces. In cooperation with the architects HENN, a modern, light-open work campus was created within 20 months, in which employees can meet and cooperate more easily and efficiently.

## General

<b>Building Type</b>	Office Buildings, Industrial and commercial construction
<b>Company Division</b>	Lindner SE   Partitions, Lindner SE   Floors, Lindner SE   Interior, Lindner SE   Heated and Chilled Ceilings
<b>Completion</b>	2018 - 2021
<b>Architect</b>	Henn Architekten

## Completed Works

- **Ceilings**  
Heated and Chilled Plasterboard Ceilings  
Plafotherm<sup>®</sup> GK HEKDA<sup>®</sup> 5400 sqm
- **Partitions**  
Partition Systems Glass  
Lindner Life Freeze 137 725 running meter  
Lindner Life Pure 620 110 running meter
- **Doors**  
Aluminium Tubular Frame Doors
- **Dry lining**  
Plasterboard partition systems
- **Floors**  
Calcium Sulphate Panels  
FLOOR and more<sup>®</sup> power 5145 sqm  
NORTEC 9300 sqm  
Floor Coverings
- **Other services**  
Kitchenette

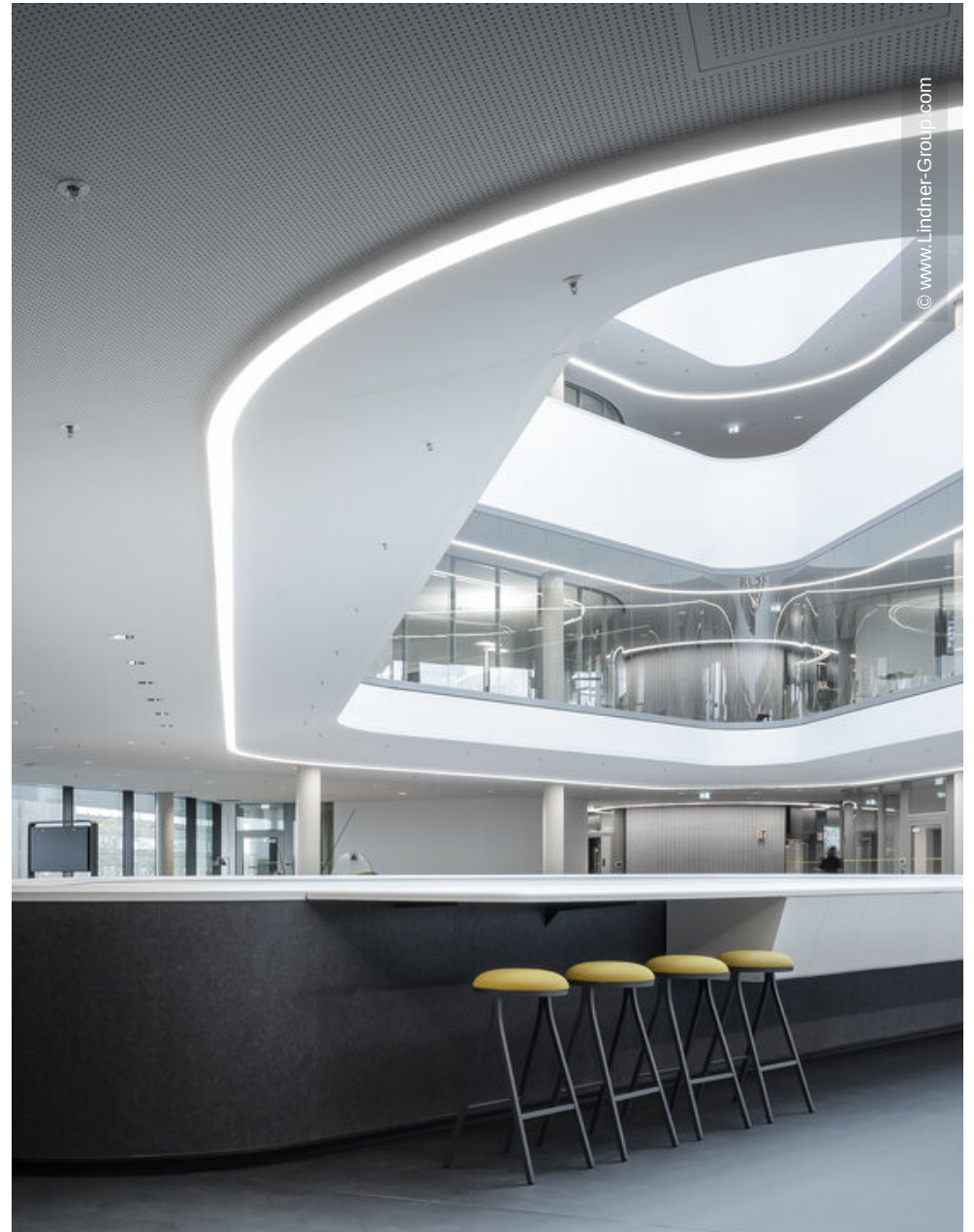





© www.Lindner-Group.com



© www.Lindner-Group.com



© www.Lindner-Group.com