

Cooperation Behrensbau - Concular

Dusseldorf, Germany

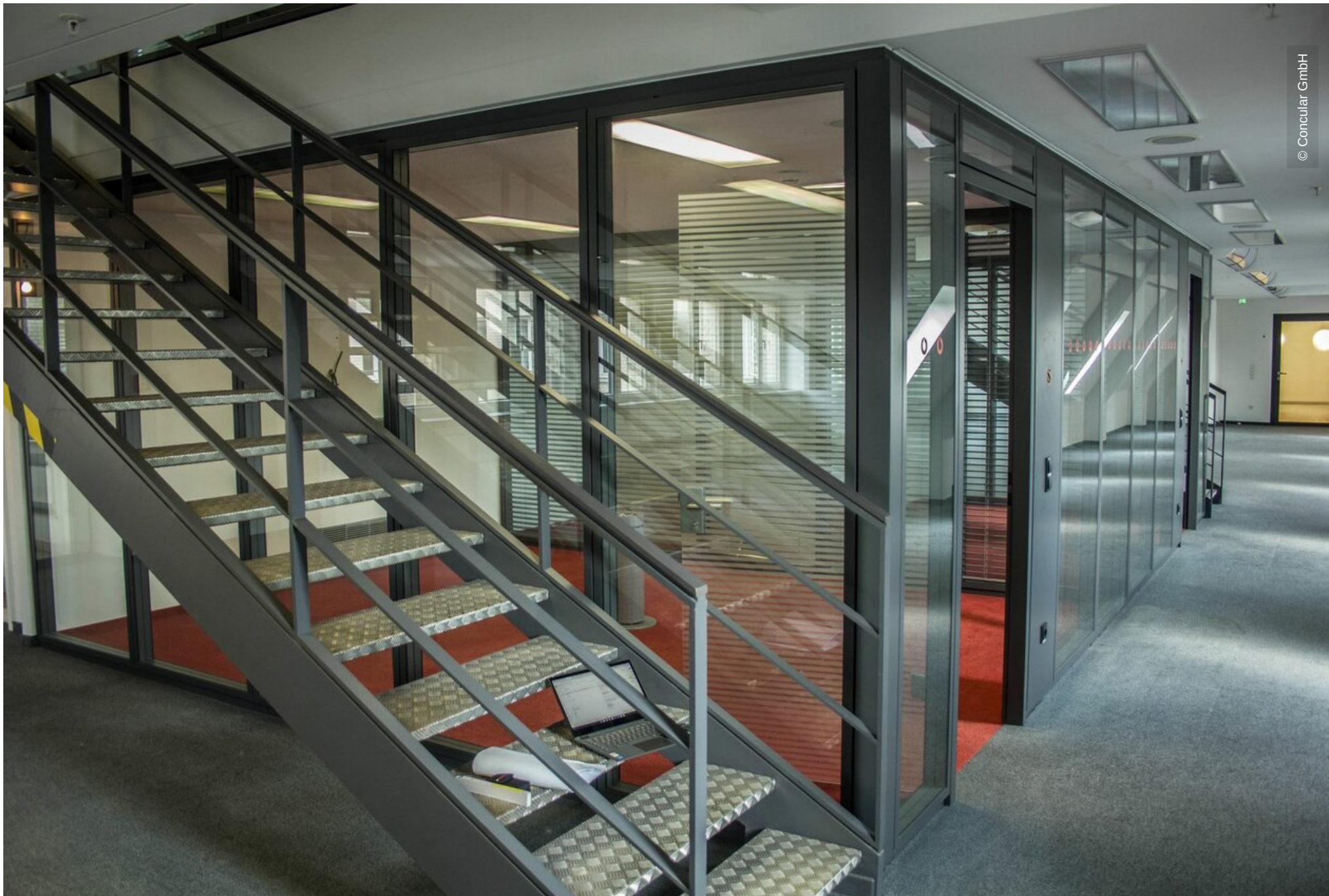



Project Description

The "Behrensbau" was built in 1911/1912 by Peter Behrens as the headquarters of the Mannesmannröhren-Werke in an atypical multifunctional and expandable design for the time. This also includes the "Mannesmann Tower" built in 1956 - also known as the "Vodafone Tower" after the takeover in 2000. As a house of history, the building, which has been a listed building since 1982, was used for the "75 Years of NRW" exhibition until the end of August 2022. This will be followed by a complete gutting and refurbishment for a new use of the time-honoured premises.

As part of the collaboration between BLB NRW and Concular, there is the opportunity to give valuable materials from the former Vodafone headquarters on Mannesmannufer (Behrensbau, Väthbau) a new life in your project. This includes products from the Lindner Group: system partition walls in various designs and glass doors were used there and are now ready for a new purpose in another building.

Together with Concular, these high-quality and unique materials were recorded during a reuse assessment.

General

Building Type	Office Buildings, Industrial and commercial construction
Company Division	Lindner SE Partitions
Completion	2020
Cooperation Partner	Concular GmbH

Completed Works

- **Partition Systems Glass**



