

MAM 7051

Grosshöflein, Austria





© paul ott fotografiert

© paul-ott

Project Description

Großhöflein: The new research and development center of the well-known Austrian baby products brand MAM. Not only modern, but also sustainable was one of the main considerations for the realization of this building. With its numerous tested and certified environmentally friendly products, Lindner was able to take on the execution of various trades in the area of interior fit-out. After the groundbreaking ceremony in April 2020, the geothermal building has been ready for occupancy since November 2021. Lindner realized the raised floor system, the plasterboard walls, plasterboard ceilings and the baffle ceilings.

Baffle Ceilings
LMD-L 601

- Plasterboard ceiling systems
Plasterboard partition systems

General

Building Type	Office buildings
Company Division	Lindner GmbH Doors
Completion	2020 - 2021
Client	Porr Bau GmbH

Completed Works

- Floors

Calcium Sulphate Panels	
NORTEC	500 sqm
NORTEC power	10 sqm
Chipboard Panels	
LIGNA	1700 sqm

- Ceilings



© paul ott fotografiert

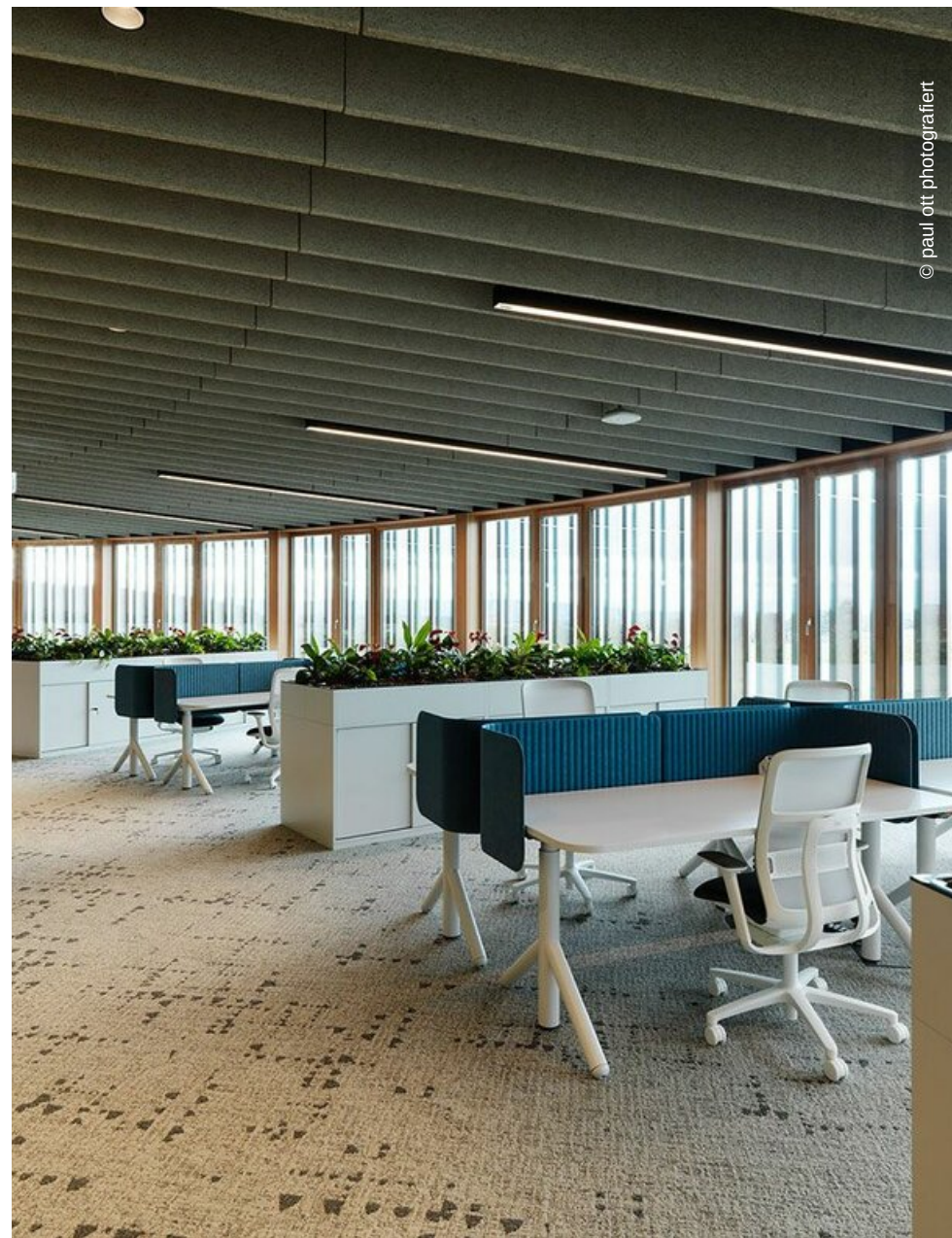

© paul ott fotografiert

