

Tenant Fit-out Comet Yxlon

Hamburg, Germany

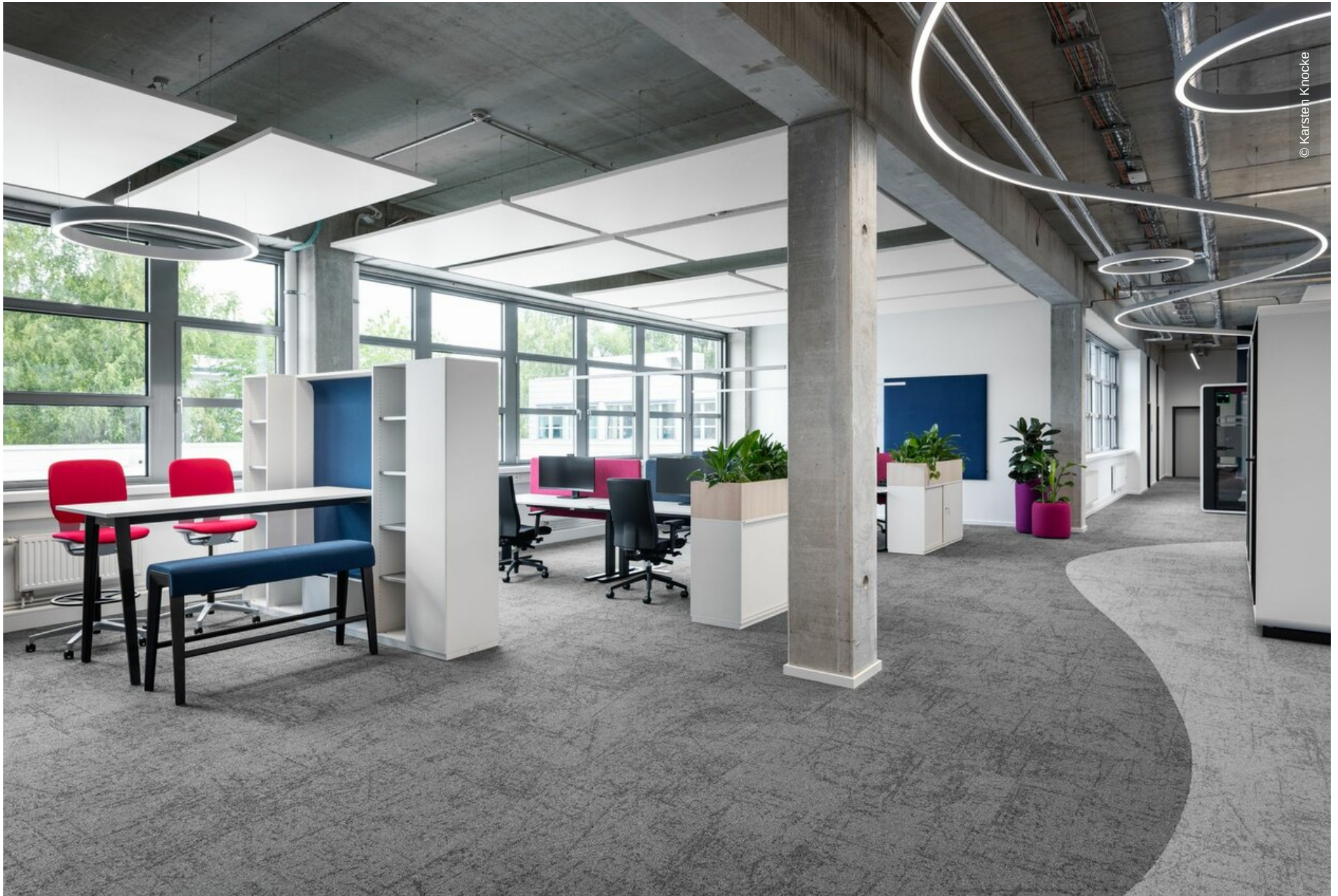



© Karsten Knocke

Project Description

For the X-ray and CT system solutions manufacturer Comet Yxlon, a pilot area for new offices was established in an existing building in Hamburg. This space serves as a model for the further refurbishment of the building and meets the high standards required for developing state-of-the-art inspection solutions. Initially, only part of the existing building, within one wing, was modernised while operations continued in other sections of the building.

The aim was to create an efficient and attractive working environment that promotes employee productivity and well-being. Further refurbishments are planned to follow. Lindner SE, through its Tenant Fit-Out | Design & Build division, was involved in the design and budget planning as well as cost estimation, contributing its extensive expertise across various disciplines. In collaboration with the furnishing specialist Joppich & Rieckhoff, which handled consulting, design, and furniture supply, the client received comprehensive support.

Within the office spaces, Lindner carried out the complete tenant fit-out, encompassing everything from implementation planning and demolition to the full-scale fit-out. This included all necessary trades such as painting and flooring, drywall, electrical work, and carpentry.

Lindner made a significant contribution to improving room acoustics and creating an appealing working atmosphere with high-quality products such as the Lindner Life Pure 620 glass partition wall and MUTE+® board sound absorbers. Office spaces were further enhanced with Lindner lighting solutions, including Snake series light channels and Loop series pendant luminaires, providing ideal illumination and a contemporary design.

General

Building Type	Office Buildings, Facilities for Meetings, Conventions and Conferences, Industrial and commercial construction
Company Division	Lindner SE Fit-Out North.Northwest Germany
Completion	2024
Client	Comet Yxlon GmbH
Partner	Joppich & Rieckhoff

Completed Works

- **Tenant fit-out**

- Demolition works
- Implementation planning
- Building services insulation
- Construction site equipment
- Floor covering works
- Electrical works
- Plasterboard ceiling systems
- Plasterboard partition systems
- Painting works
- Cleaning works
- Sanitary work
- Kitchenette
- Carpentry
- Dry construction works
- Fire detection technology
- Lighting design

- **Building services engineering**

- **Partitions**

- Partition Systems Glass
- Lindner Life Pure 620

- **Luminaires**

- Suspended luminaires
- Loop
- Light channels
- Snake

