

Parc des Princes

Paris, France





© www.Lindner-Group.com

Project Description

The Parc des Princes, one of France’s most renowned rugby and football stadiums, is located in the 16th arrondissement of Paris and has been the home of the prestigious football club Paris Saint-Germain since the late 1970s. With a capacity of approximately 49,000 seats, the stadium offers a first-class atmosphere for sports enthusiasts.

For the exclusive reception and entrance area of the stadium as well as one of the salons, Lindner’s LMD-L 607 metal louvre ceilings were installed. This solution impresses with its minimal suspension height, as the special fixing method allows direct attachment to the raw ceiling – making it ideal for rooms with limited height. The customisable louvre spacing and dimensions provide a high degree of design flexibility. Additionally, the visible ceiling void allows for easy integration of technical installations, offering both aesthetic and functional benefits.

General

Building Type	Stadiums and arenas, Assembly Rooms, Places of Assembly
Company Division	Lindner France SASU
Completion	2014 - 2015

Completed Works

- **Ceilings**

Baffle Ceilings

LMD-L 607

2087 sqm

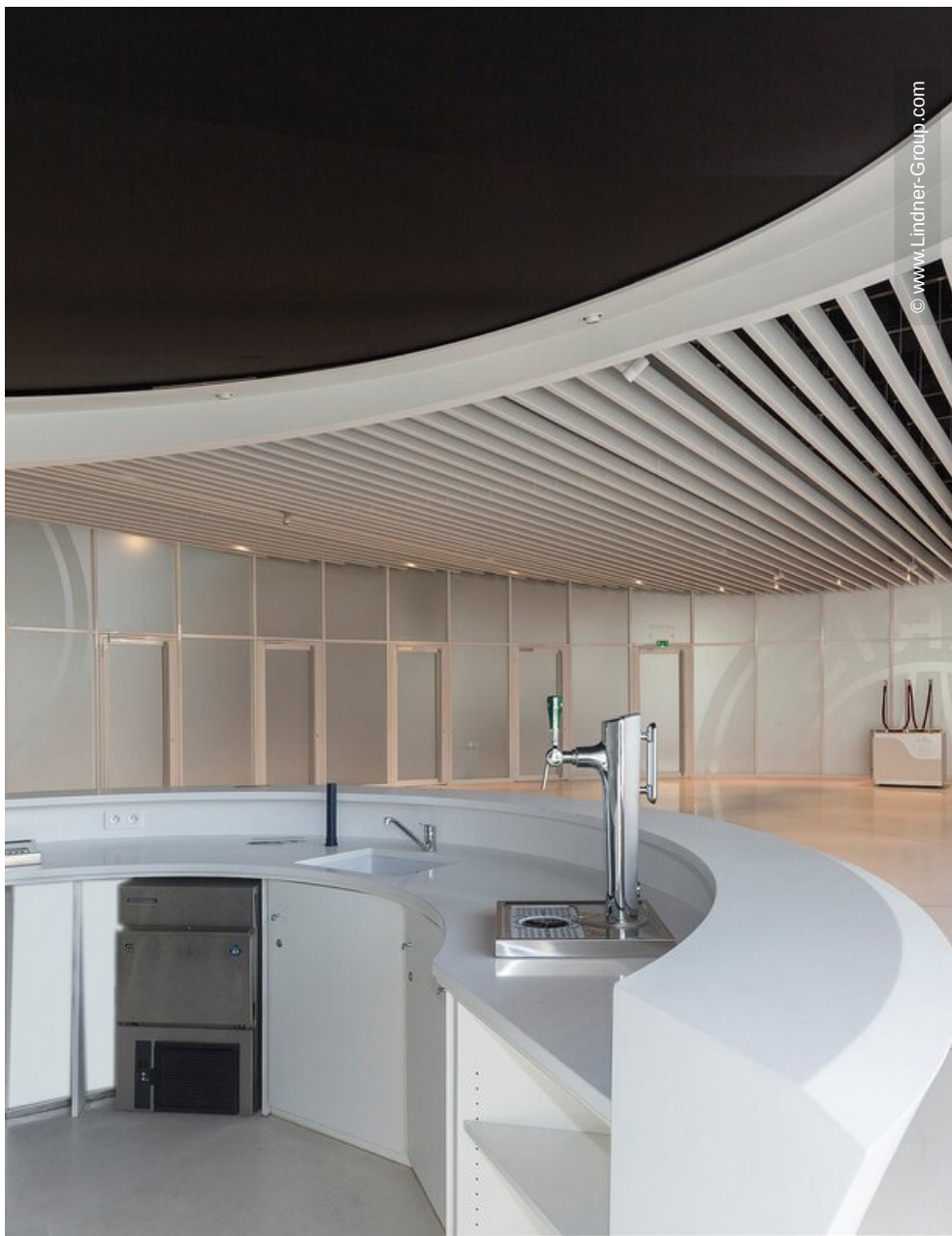

© www.Lindner-Group.com



© www.Lindner-Group.com

