

**Lindner LAOLA Wave Baffle Ceiling
was used in the office of a New York
financial institution to provide a 3-
dimensional aesthetic to the space.**

Jersey City, United States

 **Lindner**



© Colin Miller Photography

Project Description

Lindner LAOLA Wave Baffle Ceiling was used in the office of a New York financial institution to provide a 3-dimensional aesthetic to the space.

General

Building Type	Office buildings
Company Division	Lindner USA Inc.
Completion	2018 - 2019
Client	Gramercy Group Inc.
Architect	The Switzer Group

Completed Works

- **Ceilings**

- Baffle Ceilings

- LMD-L LAOLA

- Wall and ceiling panels

- COMPlacq



© Colin Miller Photography

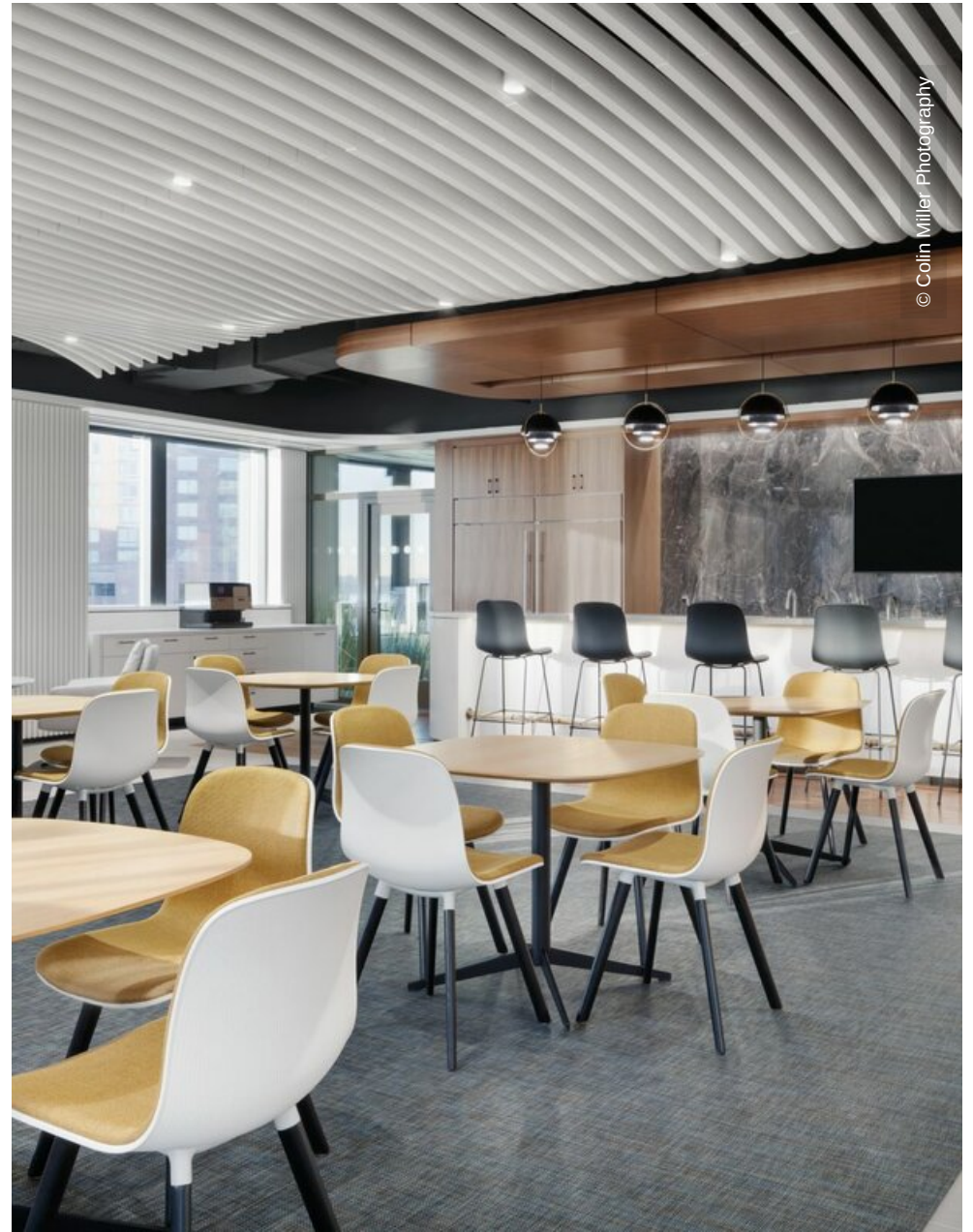

© Colin Miller Photography