

Lawrence Public Library

Lawrence, United States





© Tim Griffith

Project Description

he LMD-L 601 metal baffle ceiling found its perfect application in the public library in Lawrence.

This innovative ceiling solution is characterised by a visible substructure in the form of a suspended rail grid. One of the many advantages of the Lindner LMD-L 601 ceiling is the flexibility in the choice of centre distances, which allows the ceiling construction to be individually adapted to the room design. Another plus point is the ability to use the ceiling void efficiently to accommodate ventilation systems, which keeps the space above the ceiling open and thus optimises the total usable area. In addition, the free spaces between the baffles offer sufficient room for the integration of various installations, such as lights, sprinkler systems or the suspension of signs and information boards. For improved acoustics in the library, perforated baffles with special inserts can be used for effective sound absorption.

Completed Works

- **Ceilings**
Baffle Ceilings
LMD-L 601

General

Building Type	Library, Public and institutional buildings
Company Division	Lindner USA Inc.
Completion	2014
Client	Drewco Inc.
Architect	Gould Evans

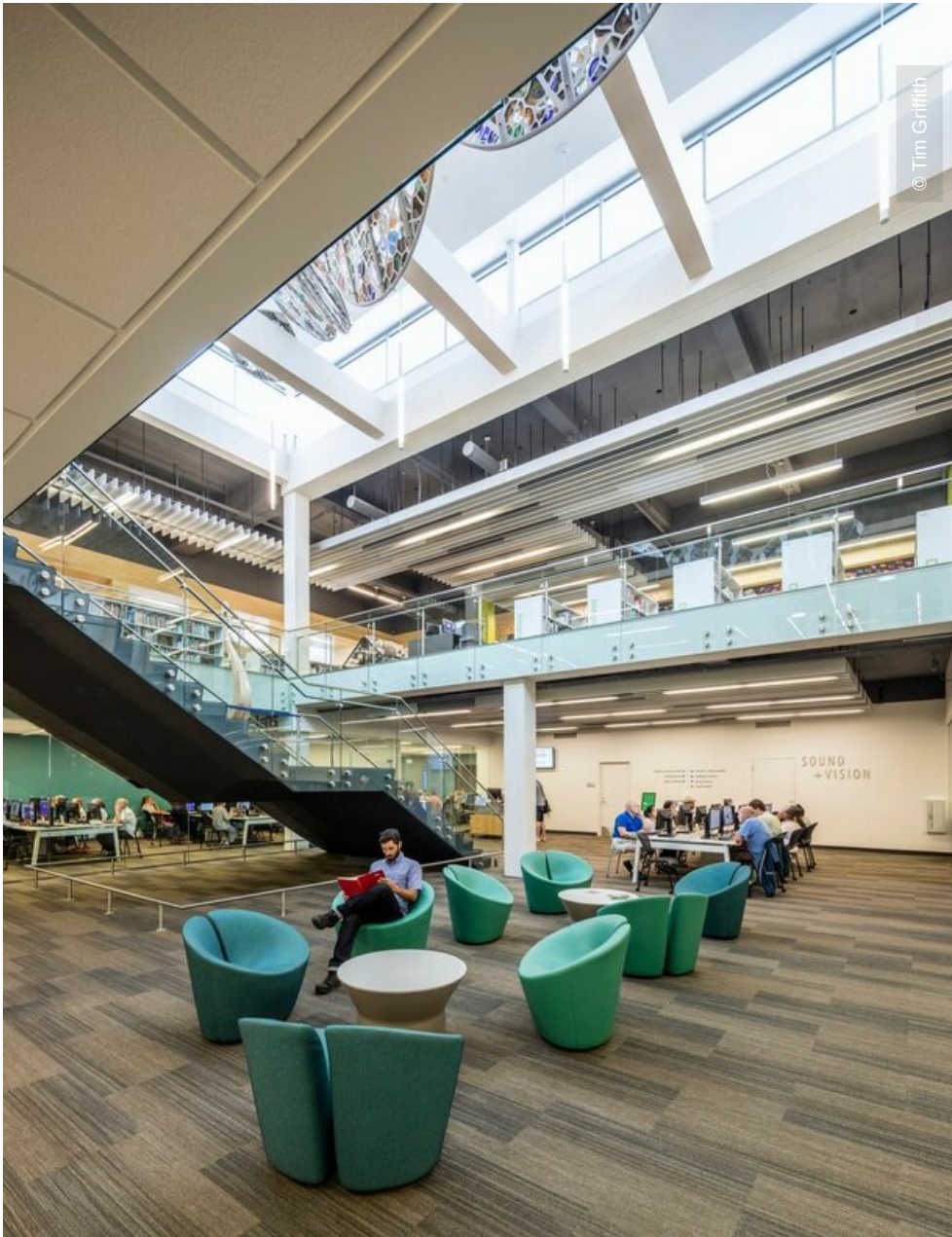

© Tim Griffith



© Tim Griffith

